

ES3 Ex-Proof Audible Signalling Sounder

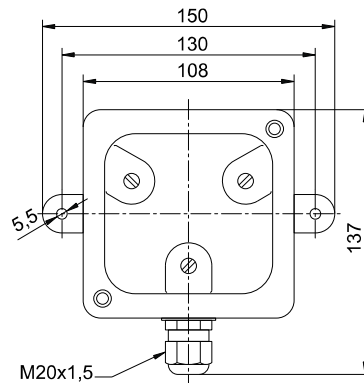
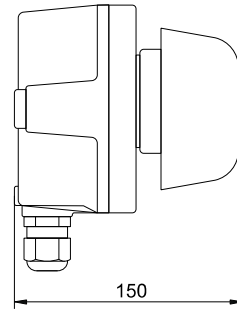

Features

- Explosion-proof signalling sounder for universal applications
- In explosion endangered areas in the industry
- 4 tone types and tone frequencies selectable via DIP switch
- Power supply 110-230 Vac

Approvals

- ATEX certificate: BVS 03 ATEX E430
EN 60079-0 : 2006, EN 60079-7 : 2003,
EN 60079-11 : 2007, EN 60079-18 : 2004

Tone settings

Tone type	DIP Switch	Tone Sequence Tone	
Single tone	□□□□	180ms on	70ms off
	□□□□	120ms on	50ms off
	□□□□	60ms on	25ms off
	□□□□	Continuous tone	
Two tone 931-1253Hz	□□□□	5Hz	
	□□□□	10Hz	
	□□□□	15Hz	
	□□□□	20Hz	
Three tone 800-1067-1333Hz	□□□□	5Hz	
	□□□□	10Hz	
	□□□□	15Hz	
	□□□□	20Hz	
Wobble tone	□□□□	1,6Hz	
	□□□□	3,6Hz	
	□□□□	3,9Hz	
	□□□□	7,8Hz	

Technical data

Type	AS3
Ingress protection	IP66
Temperature range	-20° to +40°C
Sound pressure	90dB
Housing, colour	aluminium die cast, black RAL 9005 upper part polycarbonate
Mounting	wall or ceiling
Weight	0,9kg
Power supply	110-230Vac +10% -15%
Acoustic signalling	loudspeaker
Tone types	single/two/three or wobble tone selectable via DIP switch
Tone frequencies	5 to 20Hz in 4 settings adjustable via DIP switch
Terminal	1,5mm ² single or fine wire
Cable entry	1 x M20x1,5
Insulation class	I
Equipotential bonding	connection inside housing
Current intensity	IK ≤ 3A

Order data

Type	Order nr.	Classification	Denomination	Tone options		Nominal Voltage
				Tone types	Sound press.	
AS3	410 300 004	1	Ex-proof audible signalling sounder	4	90dB	110-230Vac, 50-60Hz

¹ Zone 1,2
II 2G Ex e ib mb IIC T6

