



# SERIES 1930 - DOUBLE-POLE ROCKER SWITCHES IP 65

TO 20 (4) A 250 V AC



## PRODUCT FEATURES

- Illuminated and non-illuminated variants with various switching functions
- IP 65 with integrated gasket for high dust and water protection
- Inrush current (capacitive) up to 120 A
- Approval for 400 V
- 100 million times proven switching principle
- Modern rocker design
- High, flexible variety

## ON REQUEST

- Other switching functions (e.g. Changeover switch)
- Other terminal types
- Other colors
- Other printing variants
- Other lamp variants
- Cable assembly

<b>Mechanical life endurance</b>	5E4
<b>Operating force</b>	3 - 8 N
<b>Inrush current (capacitive)</b>	120 A 100 A (basic type 1939) 50 A (basic type 1934)
<b>Contact resistance (new condition)</b>	< 100 mOhm (1 A 12 V DC)
<b>Insulation resistance (new condition)</b>	> 100 MOhm (500 V DC)
<b>Proof tracking</b>	250 PTI
<b>Protection type</b>	IP 40 (terminal side), IP 65 (actuating side)
<b>Ambient temperature</b>	terminal side -30 °C ... +105 °C actuating side -30 °C ... +55 °C
<b>Flammability</b>	UL 94 V-2 UL 94 V-0 (housing and socket only)
<b>Glow wire test temperature</b>	850 °C
<b>Material</b> actuator housing terminals	PC / TPU (bellows) PA silver plated
<b>Plug force of the terminals</b>	≤ 80 N
<b>Approval marks</b>	
<b>Suitable for appliances of protection class II</b>	



# SERIES 1930 - DOUBLE-POLE ROCKER SWITCHES IP 65

TO 20 (4) A 250 V AC

<p>double-pole</p>		ON / OFF switch (DPST)														
Lighting voltage (V)		1935.3135	1935.3137	1935.3112	1935.3113	1935.3114	1935.3118	1935.3119	1935.3129	1935.3134	1935.3128	1935.3131	1935.3138	1932.1113	1932.3112	1932.3113
Actuator color / printing																
Housing color		Black	Black	Black	Black	Black	Black	Black	Black	Black	Black	Black	Black	Black	Black	Black
20 (4) A 250 V AC 1E4		<input type="radio"/>	<input type="radio"/>	<input type="radio"/>	<input type="radio"/>	<input type="radio"/>	<input type="radio"/>	<input type="radio"/>	<input type="radio"/>	<input type="radio"/>	<input type="radio"/>	<input type="radio"/>	<input type="radio"/>	<input type="radio"/>	<input type="radio"/>	<input type="radio"/>
12 (4) A 250 V AC 1E4																
10 (8) A 400 V AC 5E4		<input type="radio"/>	<input type="radio"/>													
10 (8) A 250 V AC 5E4		<input type="radio"/>	<input type="radio"/>	<input type="radio"/>	<input type="radio"/>	<input type="radio"/>	<input type="radio"/>	<input type="radio"/>	<input type="radio"/>	<input type="radio"/>	<input type="radio"/>	<input type="radio"/>		<input type="radio"/>	<input type="radio"/>	<input type="radio"/>
10 A 12 V DC													<input type="radio"/>			
6 (4) A 250 V AC 5E4																
16 A 250 V AC 1 HP		<input type="radio"/>	<input type="radio"/>	<input type="radio"/>	<input type="radio"/>	<input type="radio"/>	<input type="radio"/>	<input type="radio"/>	<input type="radio"/>	<input type="radio"/>	<input type="radio"/>	<input type="radio"/>		<input type="radio"/>	<input type="radio"/>	<input type="radio"/>
16 A 125 V AC 3/4 HP		<input type="radio"/>	<input type="radio"/>	<input type="radio"/>	<input type="radio"/>	<input type="radio"/>	<input type="radio"/>	<input type="radio"/>	<input type="radio"/>	<input type="radio"/>	<input type="radio"/>	<input type="radio"/>		<input type="radio"/>	<input type="radio"/>	<input type="radio"/>
16 A 125 V AC 1/3 HP												<input type="radio"/>				
14 A 250 V AC 3/4 HP																
14 A 250 V AC 1/2 HP																
14 A 125 V AC 1/3 HP																
14 A 125 V AC 1/4 HP																
12 A 250 V AC 1 HP																
12 A 125 V AC 1/2 HP																
Terminal type																
Terminal description		6.3	6.3	6.3	6.3	6.3	6.3	6.3	6.3	6.3	6.3	6.3	6.3	4.8	6.3	6.3
Contact distance (mm)		Ag ≥ 3	Ag ≥ 3	Ag ≥ 3	Ag ≥ 3	Ag ≥ 3	Ag ≥ 3	Ag ≥ 3	Ag ≥ 3	Ag ≥ 3	Ag ≥ 3	Ag ≥ 3	Ag ≥ 3	Ag ≥ 3	Ag ≥ 3	Ag ≥ 3
Contact material		Ag	Ag	Ag	Ag	Ag	Ag	Ag	Ag	Ag	Ag	Ag	Ag	Ag	Ag	Ag
EN 60335 cap. 30 conform "G"																
Miscellaneous								bellows anthracite								
Stock version				<input checked="" type="radio"/>	<input checked="" type="radio"/>	<input checked="" type="radio"/>	<input checked="" type="radio"/>								<input checked="" type="radio"/>	

ROCKER SWITCHES  
 PUSHBUTTON SWITCHES  
 TOGGLE SWITCHES  
 SLIDE SWITCHES  
 ROTARY SWITCHES  
 FOOT SWITCHES  
 TACT AND KEY SWITCHES  
 SMP-ACTION SWITCHES  
 MICRO-SIGNAL SWITCHES  
 SENSORS  
 ECO  
 PUSH IN DRIVE



# SERIES 1930 - DOUBLE-POLE ROCKER SWITCHES IP 65

TO 20 (4) A 250 V AC

		ON / OFF switch (DPST)										Normally closed contact (DPNC)		Normally open contact (DPNO)	
Lighting voltage (V)		1932.3114	1932.3116	1932.3118	1932.3130	1932.3131	1932.3132	1932.3136	1932.3137	1932.3412	1932.3312	1932.3314	1935.3218	1932.3413	
Actuator color / printing															
Housing color															
20 (4) A 250 V AC 1E4		<input type="radio"/>	<input type="radio"/>	<input type="radio"/>	<input type="radio"/>	<input type="radio"/>	<input type="radio"/>	<input type="radio"/>	<input type="radio"/>	<input type="radio"/>					
12 (4) A 250 V AC 1E4															
10 (8) A 400 V AC 5E4															
10 (8) A 250 V AC 5E4		<input type="radio"/>	<input type="radio"/>	<input type="radio"/>	<input type="radio"/>	<input type="radio"/>	<input type="radio"/>	<input type="radio"/>	<input type="radio"/>	<input type="radio"/>					
10 A 12 V DC															
6 (4) A 250 V AC 5E4															
16 A 250 V AC 1 HP		<input type="radio"/>	<input type="radio"/>	<input type="radio"/>	<input type="radio"/>	<input type="radio"/>	<input type="radio"/>	<input type="radio"/>	<input type="radio"/>	<input type="radio"/>					
16 A 125 V AC 3/4 HP		<input type="radio"/>	<input type="radio"/>	<input type="radio"/>	<input type="radio"/>	<input type="radio"/>	<input type="radio"/>	<input type="radio"/>	<input type="radio"/>	<input type="radio"/>					
16 A 125 V AC 1/3 HP					<input type="radio"/>										
14 A 250 V AC 3/4 HP															
14 A 250 V AC 1/2 HP															
14 A 125 V AC 1/3 HP															
14 A 125 V AC 1/4 HP															
12 A 250 V AC 1 HP															
12 A 125 V AC 1/2 HP															
Terminal type															
Terminal description		6.3	6.3	6.3	6.3	6.3	6.3	6.3	6.3	6.3	6.3	6.3	6.3	6.3	
Contact distance (mm)		Ag $\geq 3$	Ag $\geq 3$	Ag $\geq 3$	Ag $\geq 3$	Ag $\geq 3$	Ag $\geq 3$	Ag $\geq 3$	Ag $\geq 3$	Ag $\geq 3$	Ag $\geq 3$	Ag $\geq 3$	Ag $\geq 3$	Ag $\geq 3$	
Contact material		Ag	Ag	Ag	Ag	Ag	Ag	Ag	Ag	Ag	Ag	Ag	Ag	Ag	
EN 60335 cap. 30 conform "G"					<input type="radio"/>	<input type="radio"/>	<input type="radio"/>			<input type="radio"/>				<input type="radio"/>	
Miscellaneous						bellows white		bellows red		single-pole occupied					
Stock version														<input type="radio"/>	

ROCKER SWITCHES

PUSHBUTTON SWITCHES

TOGGLE SWITCHES

SLIDE SWITCHES

ROTARY SWITCHES

FOOT SWITCHES

TACT AND KEY SWITCHES

SNAP-ACTION SWITCHES

MIKRO-SIGNALSCHALTER

SENSORS

ECO

PUSH'DRIVE



# SERIES 1930 - DOUBLE-POLE ROCKER SWITCHES IP 65

TO 20 (4) A 250 V AC

<p>double-pole</p>		Changeover switch (DPDT)			Changeover switch with OFF position in the center (DPDT - Center OFF)							
		1934.3112	1934.3114	1934.2114	1939.3119	1939.3125	1939.3312	1939.3314	1939.3318	1939.0454		
Lighting voltage (V)												
Actuator color / printing												
Housing color												
20 (4) A 250 V AC 1E4												
12 (4) A 250 V AC 1E4					<input type="checkbox"/>	<input type="checkbox"/>	<input type="checkbox"/>	<input type="checkbox"/>	<input type="checkbox"/>			
10 (8) A 400 V AC 5E4												
10 (8) A 250 V AC 5E4		<input type="checkbox"/>	<input type="checkbox"/>									
10 A 12 V DC												
6 (4) A 250 V AC 5E4				<input type="checkbox"/>								
16 A 250 V AC 1 HP												
16 A 125 V AC 3/4 HP												
16 A 125 V AC 1/3 HP												
14 A 250 V AC 3/4 HP					<input type="checkbox"/>	<input type="checkbox"/>						
14 A 250 V AC 1/2 HP							<input type="checkbox"/>					
14 A 125 V AC 1/3 HP					<input type="checkbox"/>	<input type="checkbox"/>			<input type="checkbox"/>			
14 A 125 V AC 1/4 HP							<input type="checkbox"/>	<input type="checkbox"/>	<input type="checkbox"/>			
12 A 250 V AC 1 HP		<input type="checkbox"/>	<input type="checkbox"/>	<input type="checkbox"/>								
12 A 125 V AC 1/2 HP		<input type="checkbox"/>	<input type="checkbox"/>	<input type="checkbox"/>								
Terminal type												
Terminal description		6.3	6.3		6.3	6.3	6.3	6.3	6.3	6.3		
Contact distance (mm)		Ag ≥ 3	Ag ≥ 3	Ag ≥ 3	Ag ≥ 3	Ag ≥ 3	Ag < 3	Ag < 3	Ag < 3	Au < 3		
Contact material		Ag	Ag	Ag	Ag	Ag	Ag	Ag	Ag	Au		
EN 60335 cap. 30 conform "G"												
Miscellaneous							momentary function both sides	momentary function both sides	momentary function both sides	single-pole occupied momentary function both sides		
Stock version					<input type="checkbox"/>		<input type="checkbox"/>	<input type="checkbox"/>				

ROCKER SWITCHES  
PUSHBUTTON SWITCHES  
TOGGLE SWITCHES  
SLIDE SWITCHES  
ROTARY SWITCHES  
FOOT SWITCHES  
TACT AND KEY SWITCHES  
SNAP-ACTION SWITCHES  
MICRO-SIGNAL SWITCHES  
SENSORS  
ECO  
PUSH IN DRIVE



# SERIES 1930 - DOUBLE-POLE ROCKER SWITCHES IP 65

TO 20 (4) A 250 V AC



Basic types 1932, 1934, 1935 and 1939 double-pole

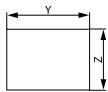

X = Wall thickness

x	y	z
0.75 ... 1.25	30 <sup>-0.1</sup>	22 <sup>+0.2</sup>
1.25 ... 3	30.2 <sup>-0.1</sup>	22 <sup>+0.2</sup>

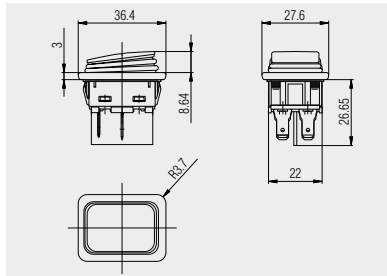

Quick-connect terminal 4.8 x 0.8 basic type 1932

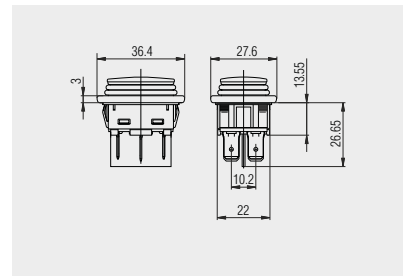

Quick-connect terminal 6.3 x 0.8 basic type 1939

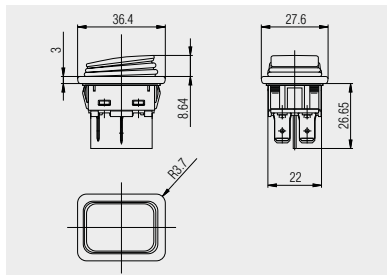

Quick-connect terminal 6.3 x 0.8 basic types 1932, 1934 and 1935

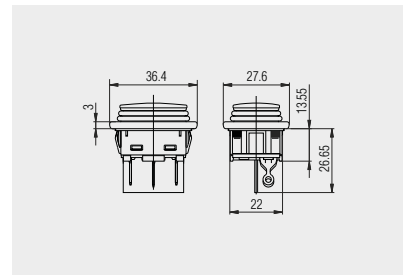

Solder terminal basic type 1939

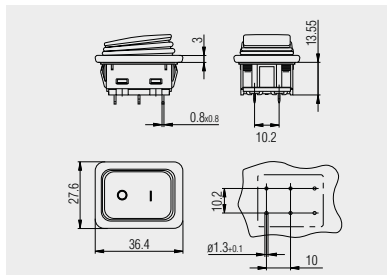

PCB terminal basic type 1934

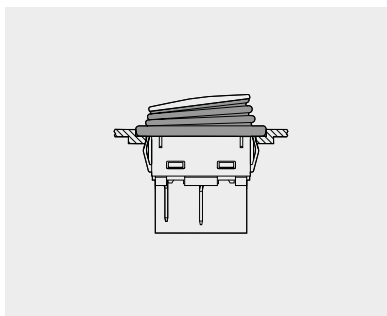

Sunken installation recommended for IP 65

A correct assembly and examination on tightness according to IP 65 in the equipment must be ensured by the customer.



Block connector 217.954.011

Block connector for cable connection for the double-pole versions of the rocker switch series 1830 und 1930.

Used with the standard timer plug AMP 0-927 936-1

# MARQUARDT INTERNATIONAL.

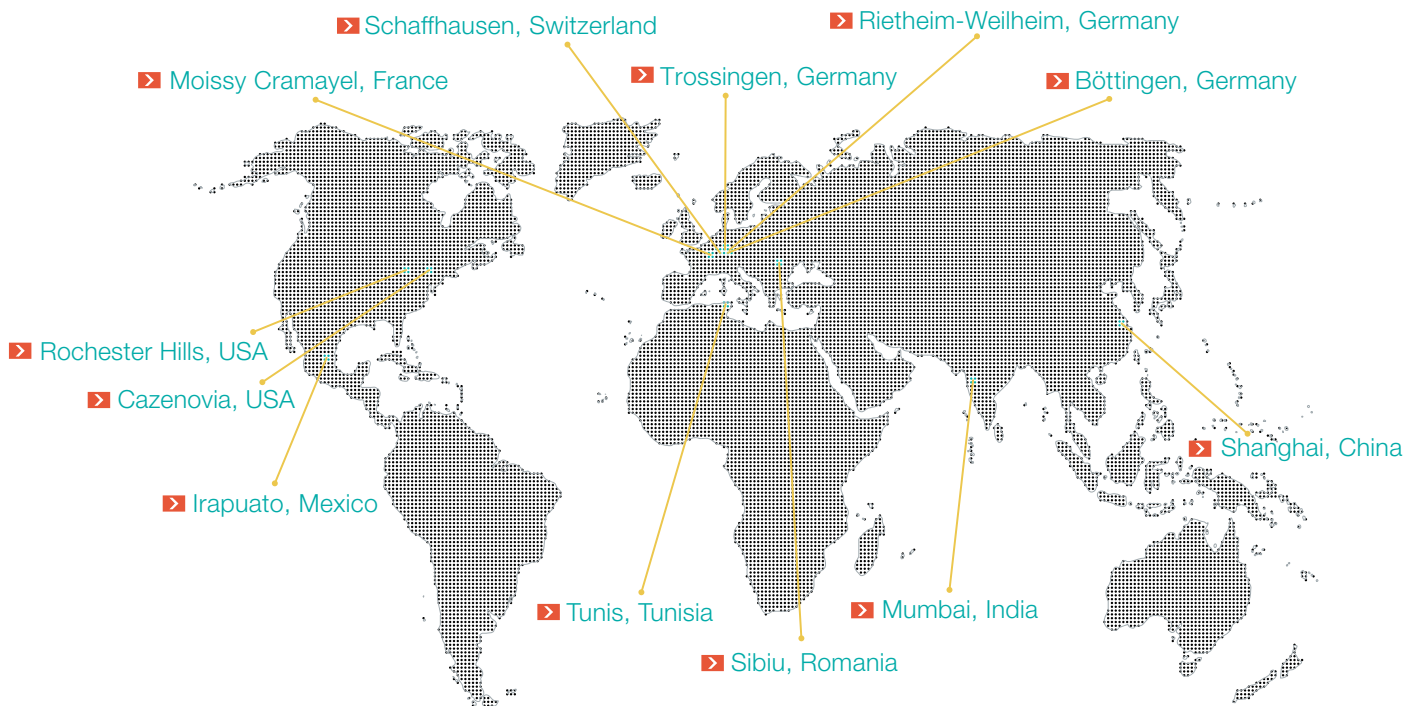

## HEADQUARTERS

### Marquardt Mechatronik GmbH

Schloss-Straße 16

78604 Rietheim-Weilheim / GERMANY

Tel. +49 (0)74 24/99-0

Fax +31 (0)74 24/99-2399

marquardt@marquardt.com

[www.marquardt.com](http://www.marquardt.com)

## Geuken



## DISTRIBUTOR

### GEUKEN B.V.

Wattstraat 25a

2723 RA Zoetermeer / NETHERLANDS

Tel. +31 (0)79 361 60 70

Fax +31 (0)79 361 40 90

info@geuken.nl

[www.geuken.nl](http://www.geuken.nl)