

micro
when small matters

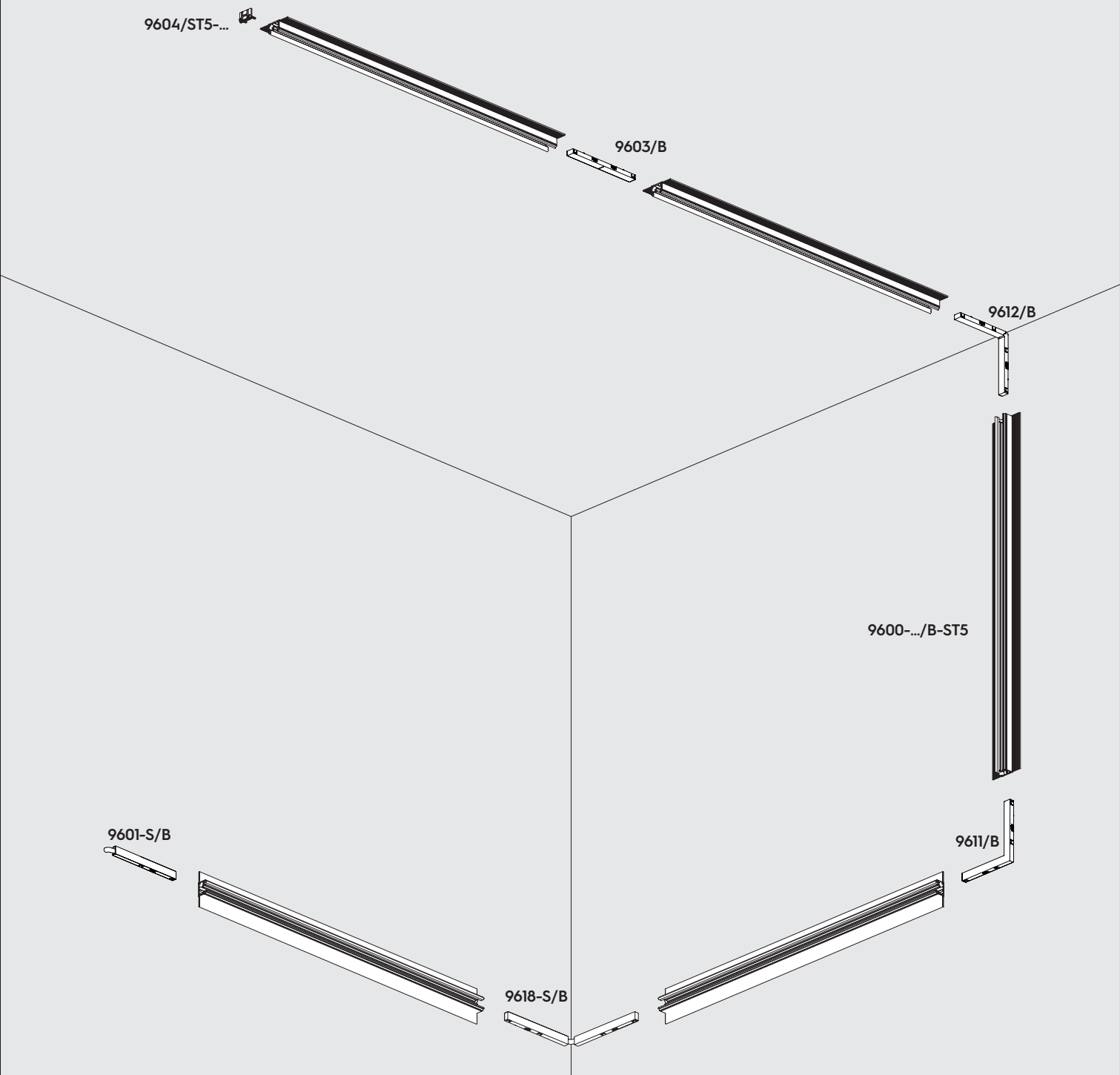

TRIMLESS INSTALLATION



1 - 9600-.../...-ST5

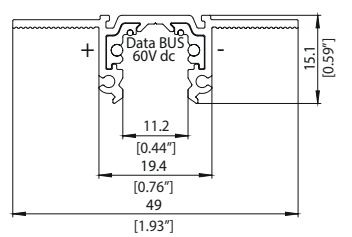
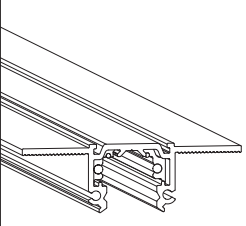
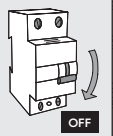

2 - USE

Trimless

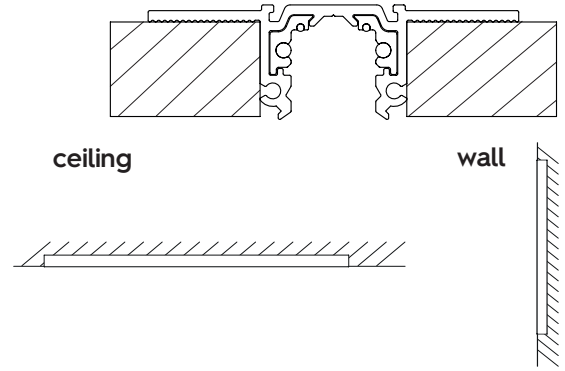

CODE	L mm [ft]	
9600-1/...-ST1	1000 [3.28]	
9600-2/...-ST1	2000 [6.56]	
9600-3/...-ST1	3000 [9.84]	

3 - CEILING FIXING

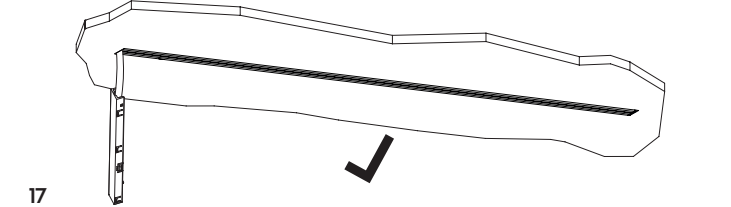
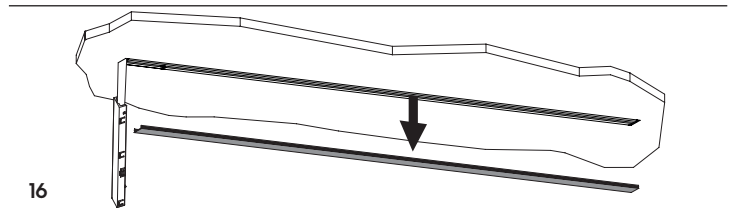
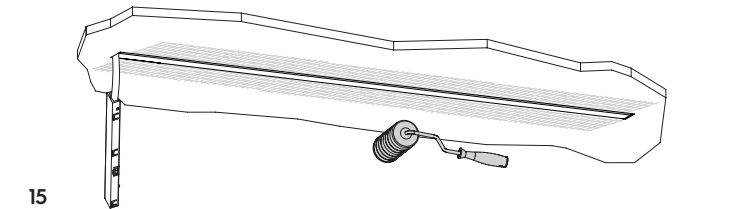
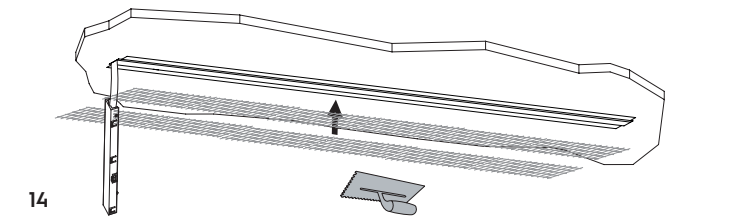
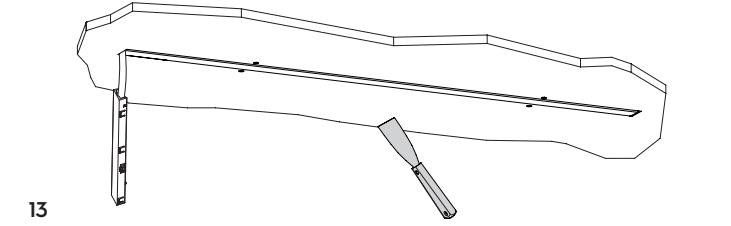
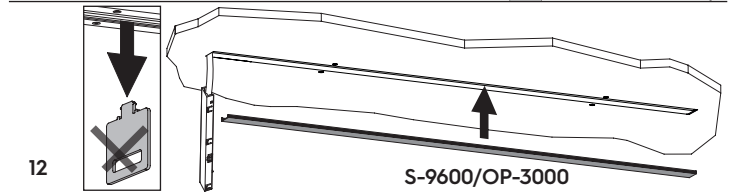
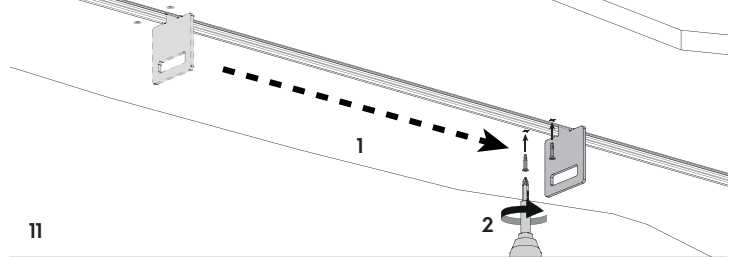
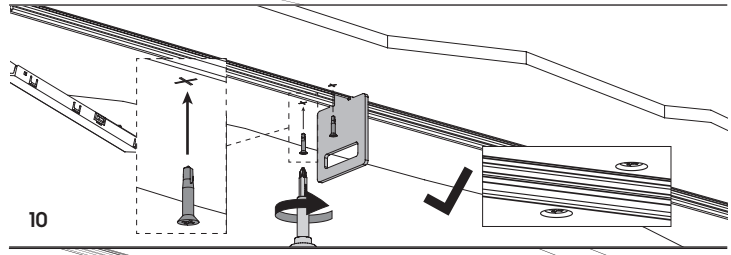
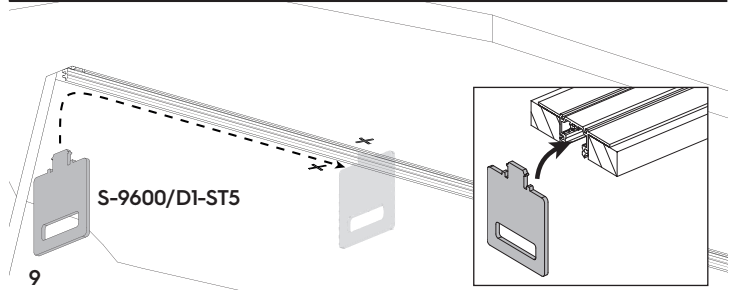
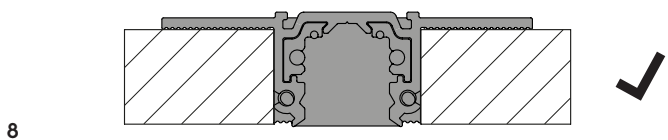
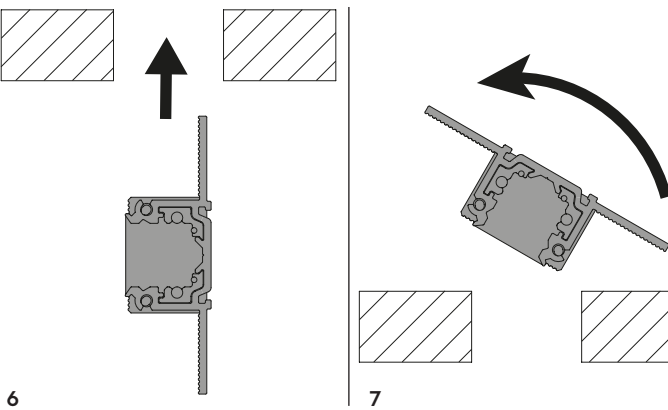
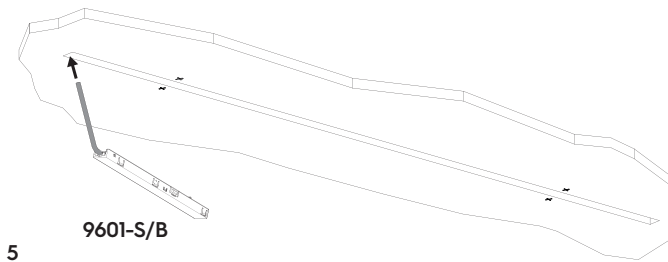
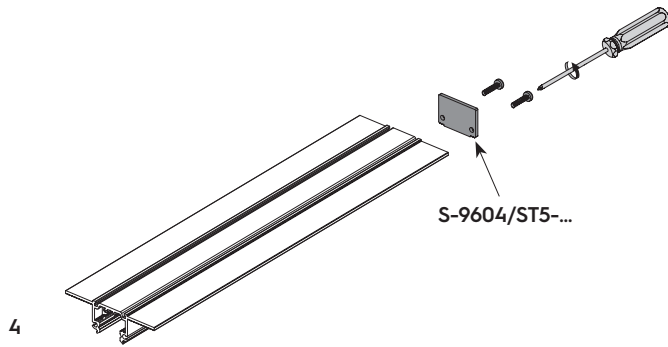
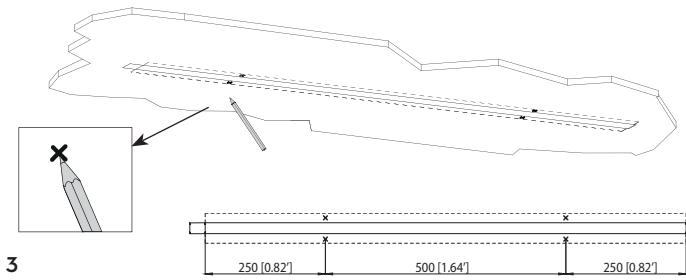
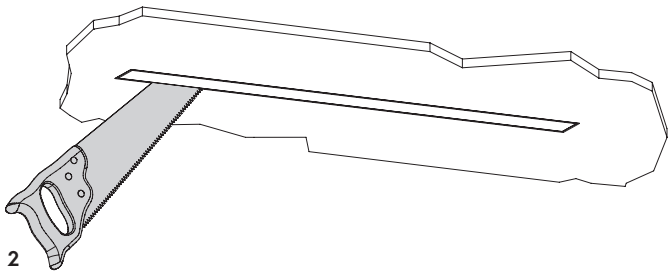
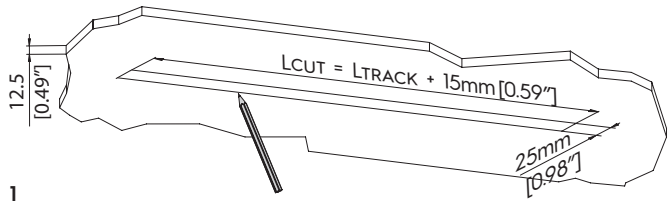

4 - IN ROW USE

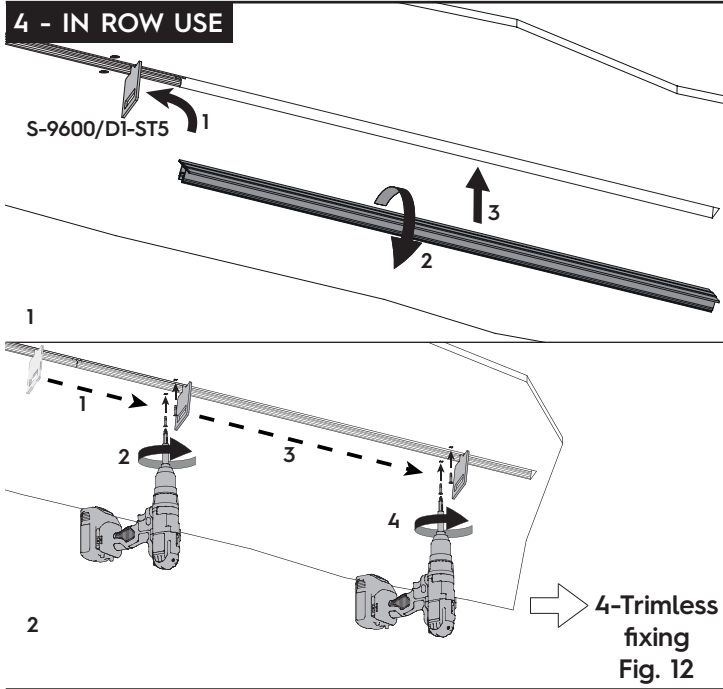

5 - 9601-S/B

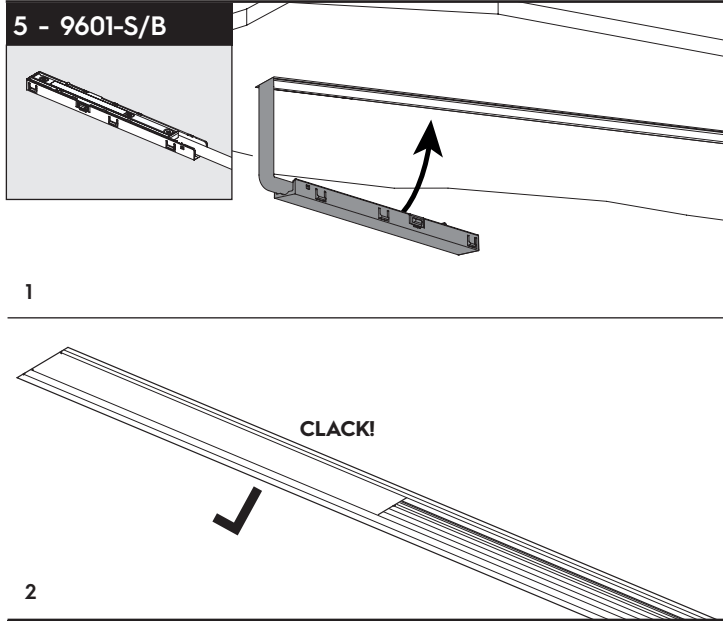

6 - 9603/B

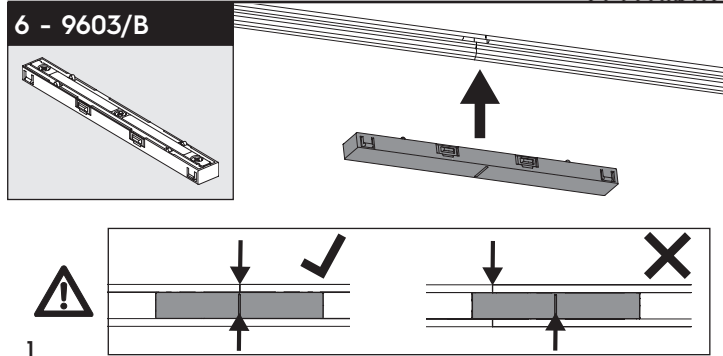

7 - WARNING

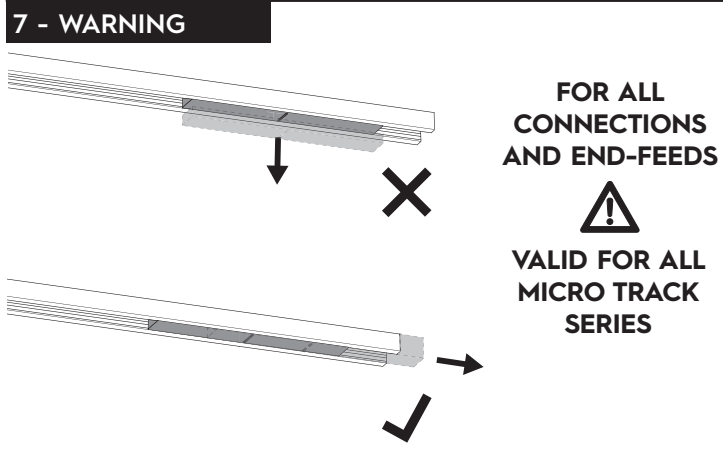

8 - CUTTING

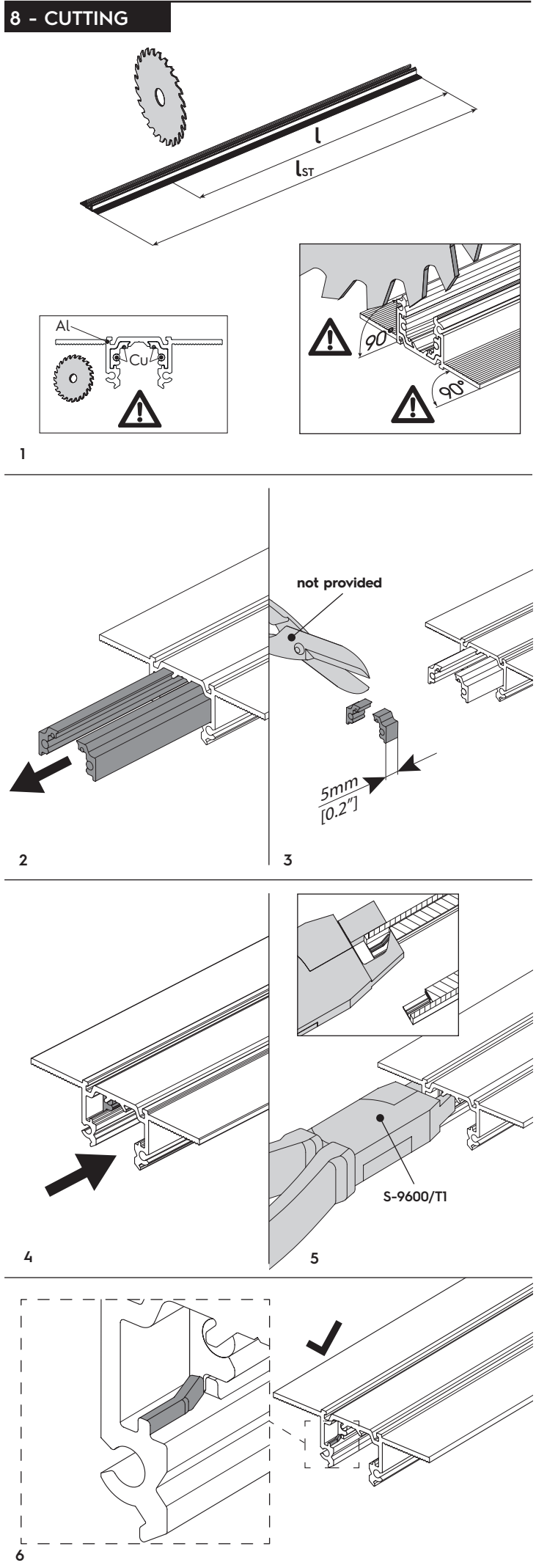



PLEASE ENSURE THAT THE DATA BUS WIRING DOES NOT CREATE A RING STRUCTURE. A FAILURE-FREE DATA BUS CANNOT BE ENSURED IF ONE IS PRESENT.

IF THE TRACK INSTALLATION REQUIRES THE USE OF "L", "T" OR "X" -SHAPED JOINT, IT IS POSSIBLE TO DISCONNECT THE DATA BUS IN THESE JOINTS TO AVOID CREATING A RING STRUCTURES.

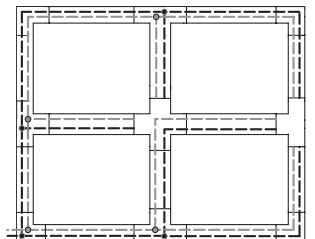
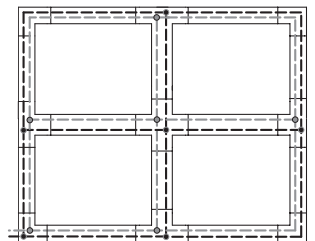

--- Bus Data