

MULTISYSTEM evo



REV. 0



ST7-E ST9-E

1 - 9500-.../...-ST7-E

CODE	L mm [ft]	
9500-1/...-ST7-E	1000 [3.28]	
9500-2/...-ST7-E	2000 [3.28]	
9500-3/...-ST7-E	3000 [3.28]	

1 - 9500-.../...-ST9-E

CODE	L mm [ft]	
9500-1/...-ST9-E	1000 [3.28]	
9500-2/...-ST9-E	2000 [3.28]	
9500-3/...-ST9-E	3000 [3.28]	

2 - USE

Suspended

3 - FIXING

7.5mm

> Ø Wire
Max 9 mm

With clamps

2

With brackets

2

3

$T_c \text{ max: } 0,7 \text{ Nm}$

S-9000/215, S-9000/216, S-9000/211-S..., S-9500/114-T, S-9000/211-..., S-9000/3, S-9000/132, S-9000/214, S-9000/215, S-9000/3, S-9000/211-S..., S-9500/317-LA + S-9000/218 + 602/F, S-9500/115-..., S-9500/317-SV-...

MAX LOAD

max 900

25Kg

450 450

36Kg

POLARITY!

1	2-3
9501-S-KL...	9501-S-KR...
9501-S-KR...	9501-S-KL...

SEE ADAPTERS WIRING INSTRUCTIONS!

1

2

3

4

5

6

$T_c \text{ max: } 1 \text{ Nm}$

4 - 9503...

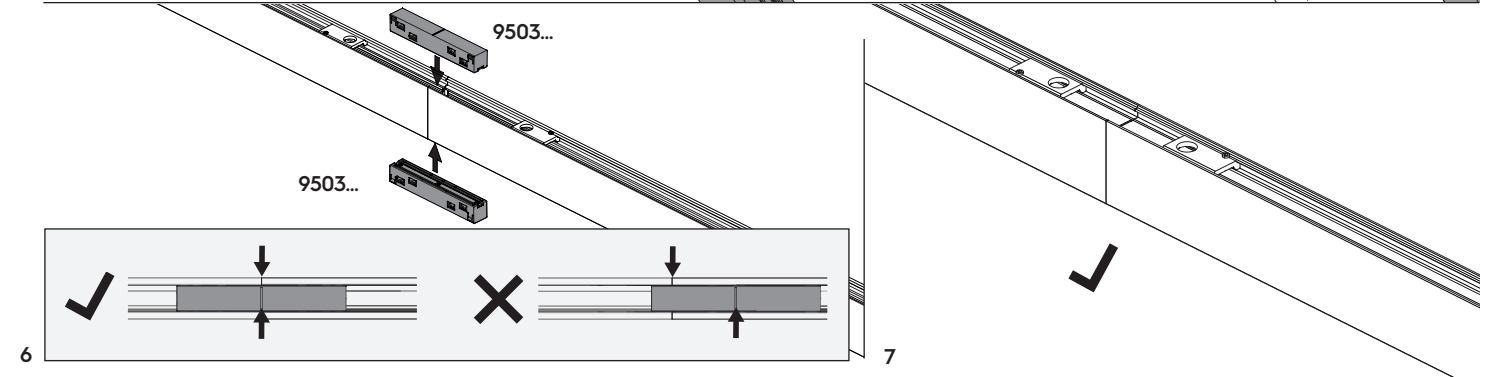
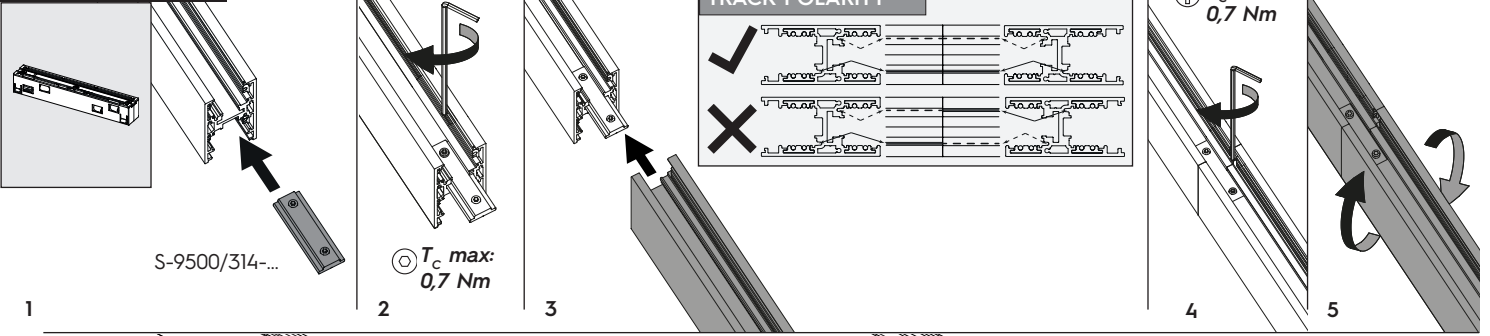

5 - CUTTING

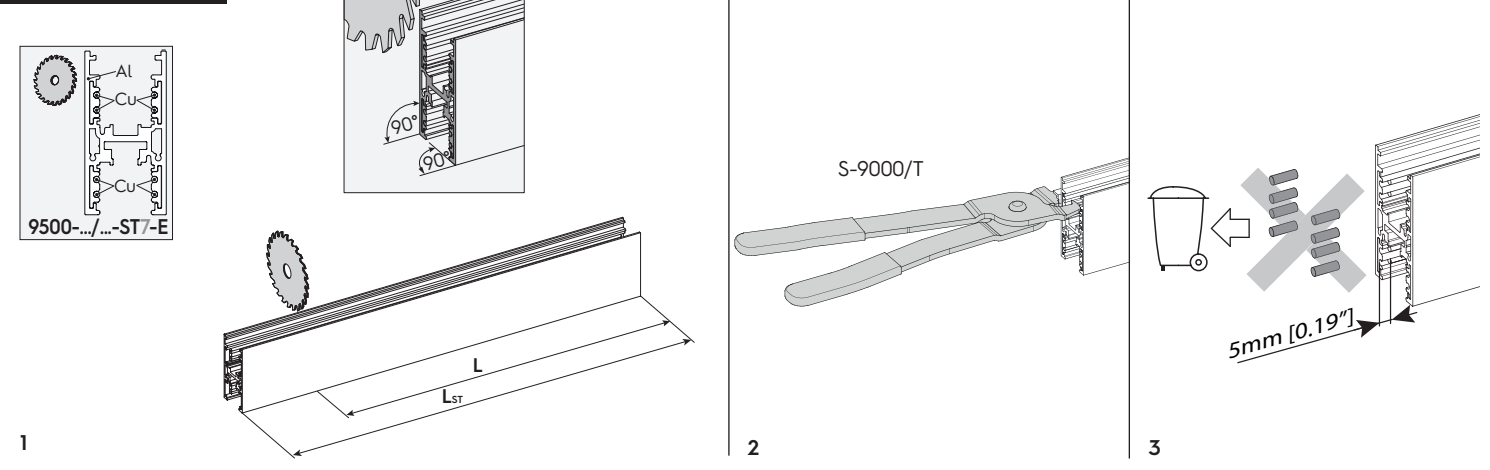

6 - 9501-S/...-E

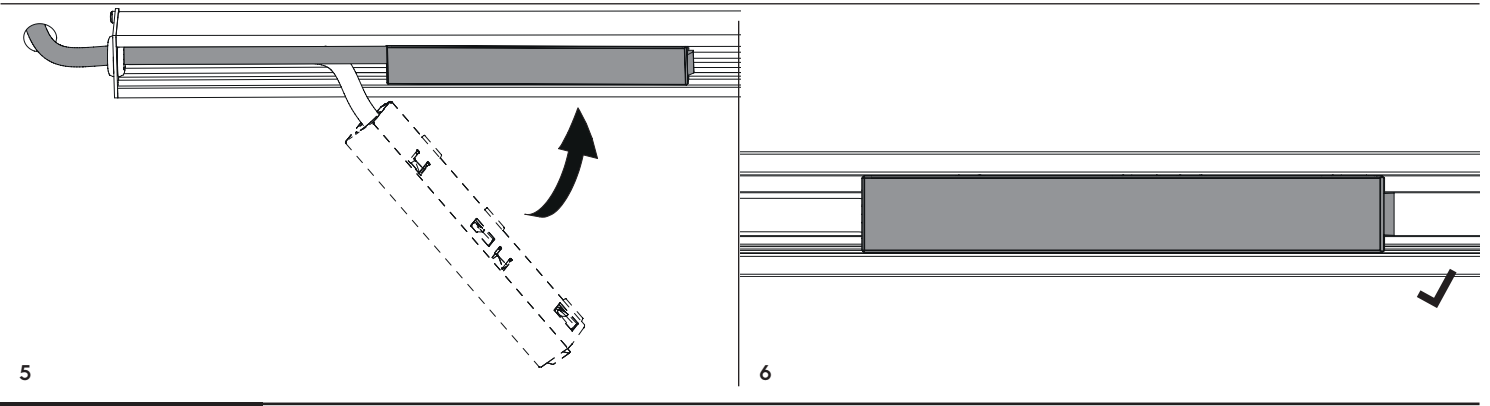
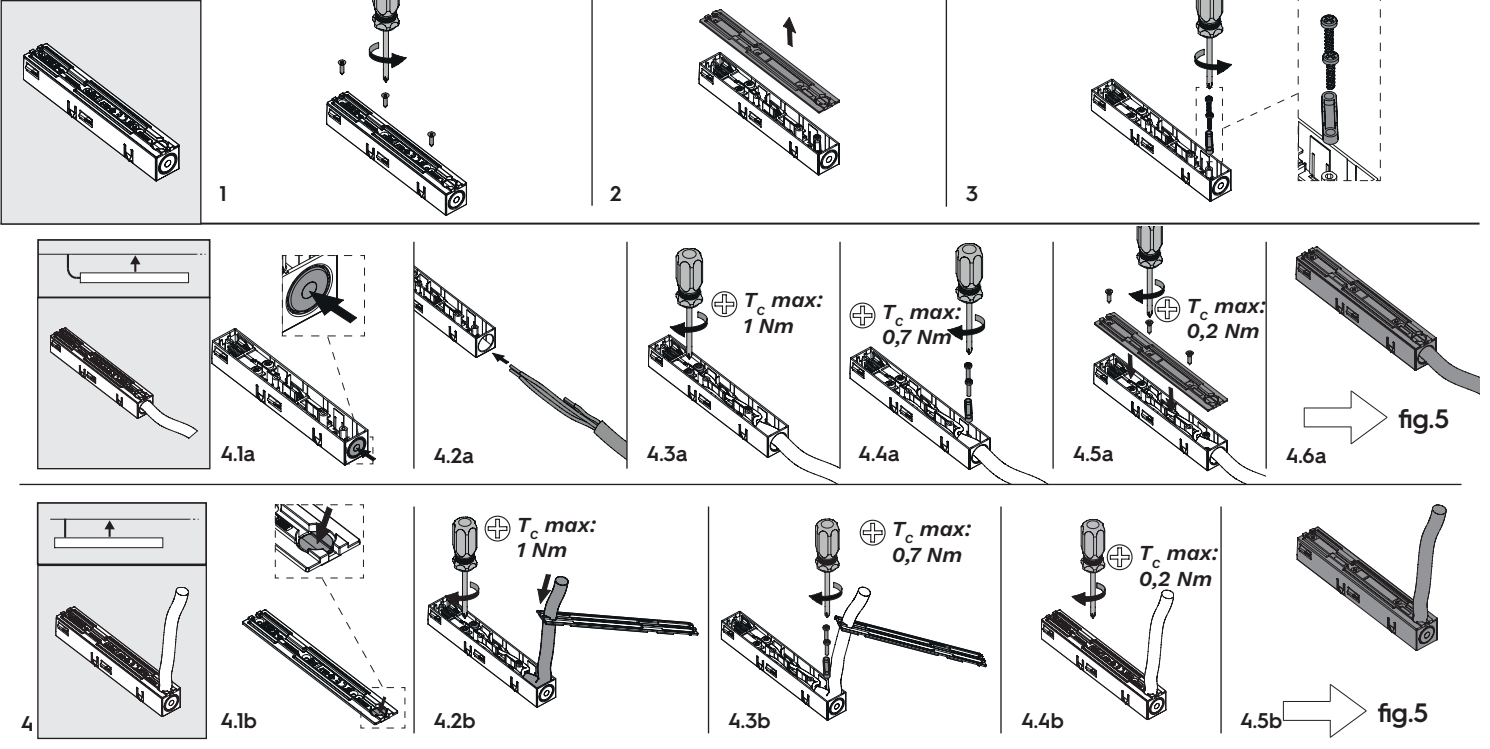

7 - 90° ANGLE

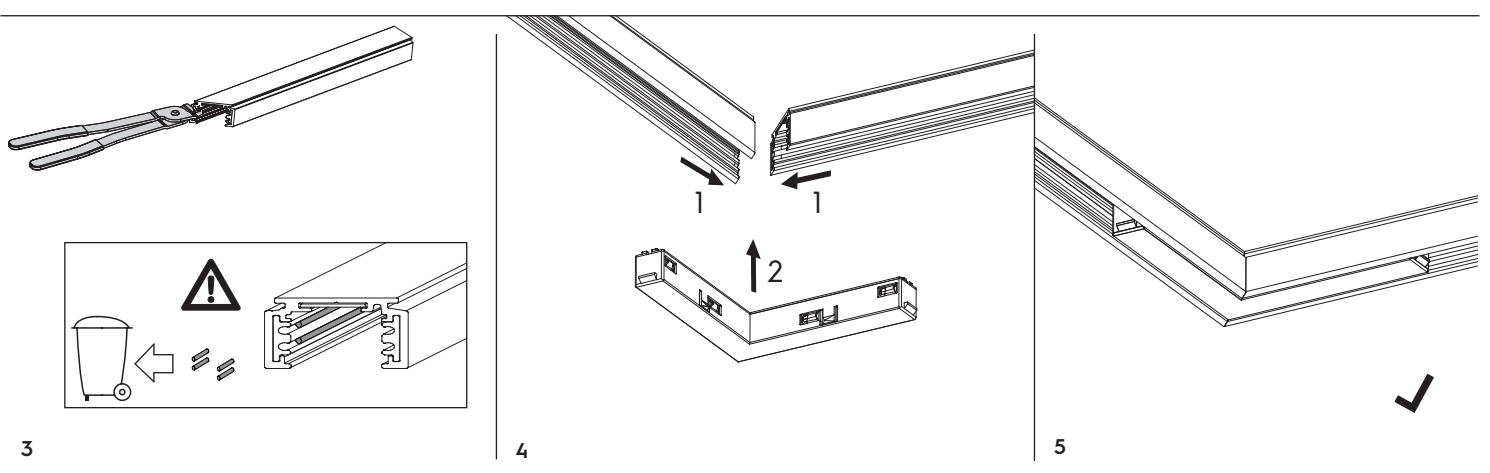
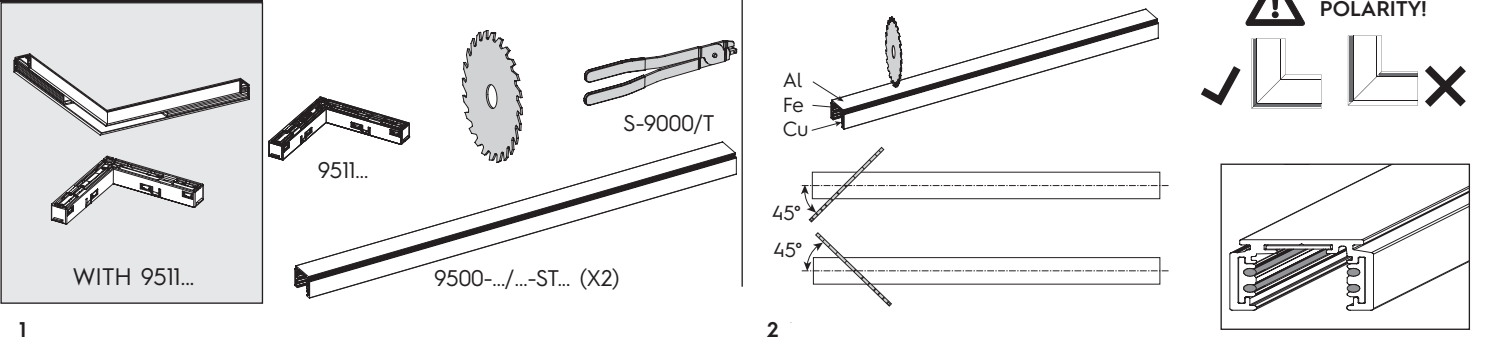

8 - ≠ 90° ANGLE

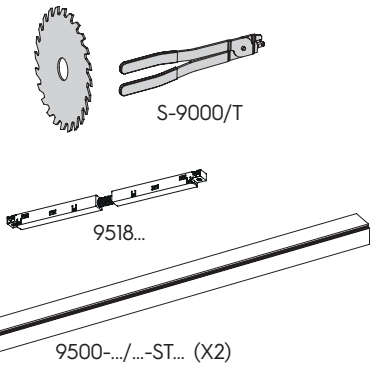

1

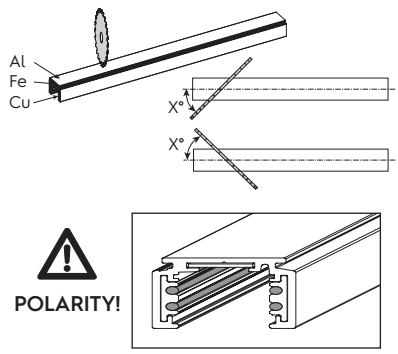

2

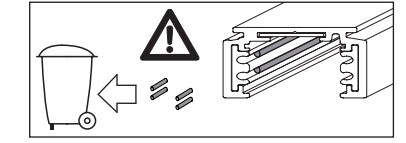
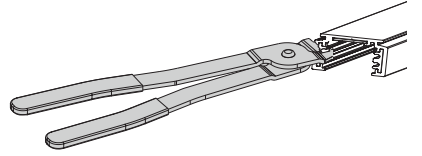

3

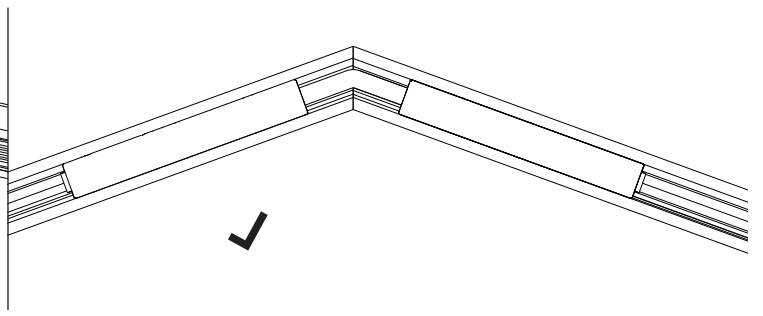
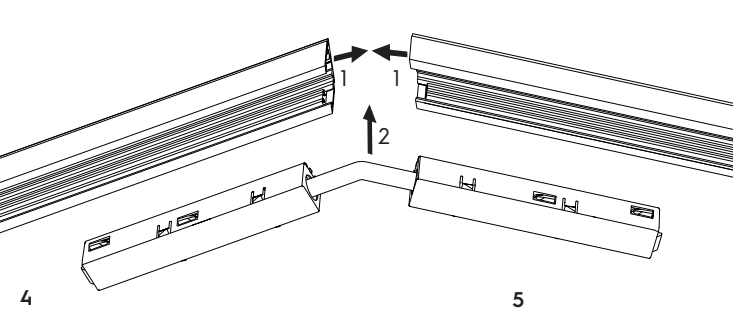

**9 - WALL CEILING
90° ANGLE**

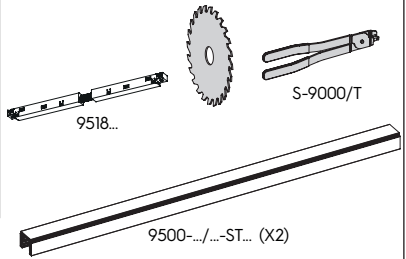

1

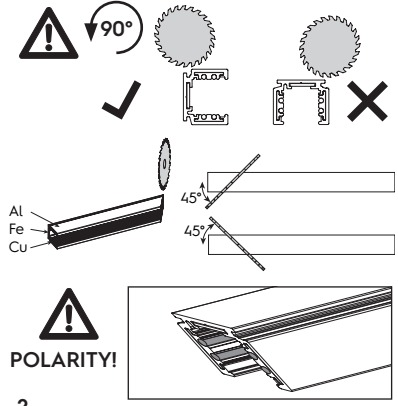

2

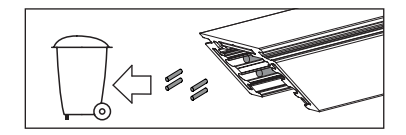
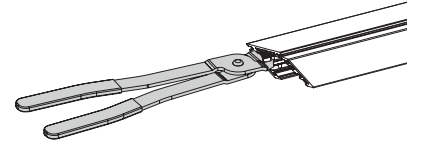

3

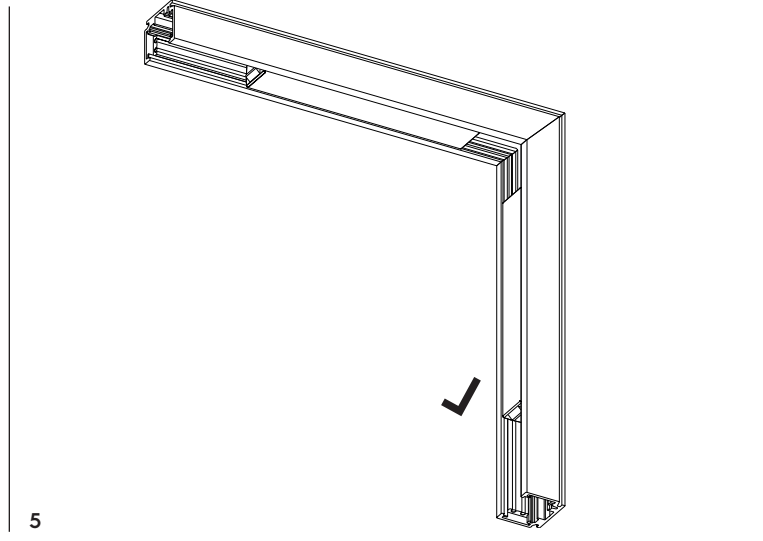
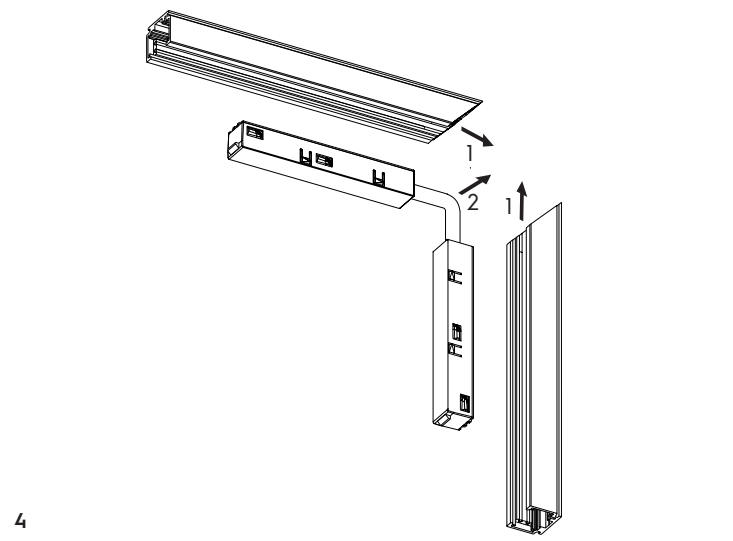

5