



SERIES 2066 - ANALOGUE PRESSURE SENSORS

FOR WATER AND AIR PRESSURE MEASUREMENT UP TO 10 BAR



PRODUCT FEATURES

- Magnetic pressure sensor with analogue output
- Long life endurance
- Robust and simple structure
- Linear measuring range
- Fully automatic 100 % test and adjustment
- Versions can be used for drinking water

ON REQUEST

- Different measuring ranges
- Adaptation of the output voltage
- Supply voltage variants
- Integrated digital switching output
- Other electrical / mechanical adaptation

Medium	heating water air water
Measuring range	0-4.5 bar / 0-65 psi / 0-450 kPa 0-10 bar / 0-145 psi / 0-1 MPa
Bursting pressure	> 9 bar / 130 psi / 0.9 MPa > 42 bar / 609 psi / 4.2 MPa (10 bar version)
Medium	+2 °C ... +90 °C
Storage	-40 °C ... +90 °C
Ambient temperature	-10 °C ... +70 °C
Sensor description	maximum current consumption < 14 mA (12 mA typ.)



SERIES 2066 - ANALOGUE PRESSURE SENSORS

FOR WATER AND AIR PRESSURE MEASUREMENT UP TO 10 BAR

	Power supply	Terminal description	Measuring range	Output signal	Miscellaneous	Stock version
Pressure sensor						
2066.2102	5 V DC (ratiometric)	4-pole with plug SNAP 2.5	0-4.5 bar / 0-65 psi / 0-450 kPa	proportional: 1.125 V at 0 bar, 3.6 V at 4.5 bar	plugging flange	
2066.2103	5 V DC (ratiometric)	4-pole with plug SNAP 2.5	0-4.5 bar / 0-65 psi / 0-450 kPa	proportional: 1.125 V at 0 bar, 3.6 V at 4.5 bar	thread flange / external thread G 3/8	
2066.2104	5 V DC (ratiometric)	4-pole with plug SNAP 2.5	0-4.5 bar / 0-65 psi / 0-450 kPa	proportional: 0.5 V at 0 bar, 2.7 V at 4.5 bar	plugging flange	
2066.2105	5 V DC (ratiometric)	4-pole with plug SNAP 2.5	0-4.5 bar / 0-65 psi / 0-450 kPa	proportional: 0.5 V at 0 bar, 2.7 V at 4.5 bar	thread flange / external thread G 3/8	
2066.2106	6 - 30 V DC	3-pole with plug SNAP 2.5	0-4.5 bar / 0-65 psi / 0-450 kPa	proportional: 0.5 V at 0 bar, 3.8 V at 4.5 bar	controlled voltage supply plugging flange	
2066.2107	6 - 30 V DC	3-pole with plug SNAP 2.5	0-4.5 bar / 0-65 psi / 0-450 kPa	proportional: 0.5 V at 0 bar, 3.8 V at 4.5 bar	controlled voltage supply thread flange / external thread G 3/8	
2066.2112	5 V DC (ratiometric)	4-pole with plug SNAP 2.5	0-4.5 bar / 0-65 psi / 0-450 kPa	proportional: 1.125 V at 0 bar, 3.6 V at 4.5 bar	plugging flange	
2066.3101	5 V DC (ratiometric)	3-pole with plug SNAP 2.5	0-10 bar / 0-145 psi / 0-1 MPa	proportional: 0.5 V at 0 bar, 3.5 V at 10 bar	thread flange / external thread G 3/8	
2066.3102	5 V DC (ratiometric)	3-pole with plug SNAP 2.5	0-10 bar / 0-145 psi / 0-1 MPa	proportional: 0.5 V at 0 bar, 3.5 V at 10 bar	plugging flange	

Further information under

WWW.MARQUARDT-SWITCHES.COM

ROCKERSWITCHES

PUSHBUTTON SWITCHES

TOGGLE SWITCHES

SLIDE SWITCHES

ROTARY SWITCHES

FOOT SWITCHES

TACT AND KEY SWITCHES

SNAP-ACTION SWITCHES

MICRO-SIGNAL SWITCHES

SENSORS

ECO

PUSH'N'DRIVE



SERIES 2066 - ANALOGUE PRESSURE SENSORS

FOR WATER AND AIR PRESSURE MEASUREMENT UP TO 10 BAR



Basic type 2066 (plugging flange)
4.5 bar version

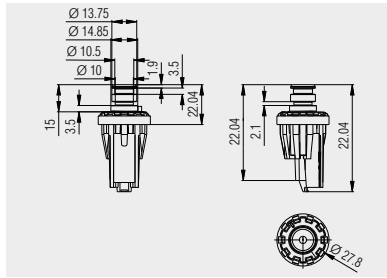

☐ Snap fastening 4-pole with
plug SNAP 2.5



Basic type 2066 (thread flange)
4.5 bar version

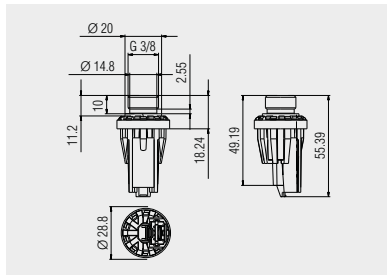

☐ Snap fastening 4-pole with
plug SNAP 2.5



Basic type 2066 (plugging flange)
10 bar version

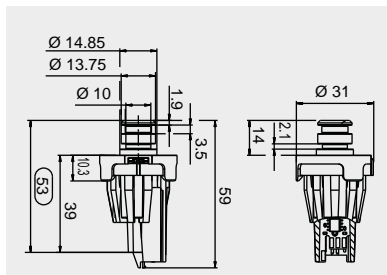

☐ Snap fastening 3-pole with
plug SNAP 2.5



Basic type 2066 (thread flange)
10 bar version

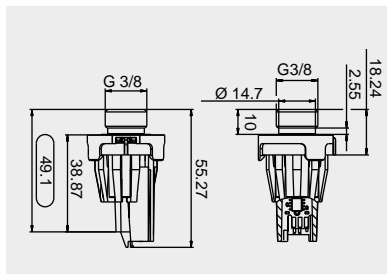

☐ Snap fastening 3-pole with
plug SNAP 2.5

ROCKER SWITCHES
PUSHBUTTON SWITCHES
TOGGLE SWITCHES
SLIDE SWITCHES
ROTARY SWITCHES
FOOT SWITCHES
TACT AND KEY SWITCHES
SNAP-ACTION SWITCHES
MICRO-SIGNAL SWITCHES
SENSORS
ECO
PUSH IN DRIVE

MARQUARDT INTERNATIONAL.

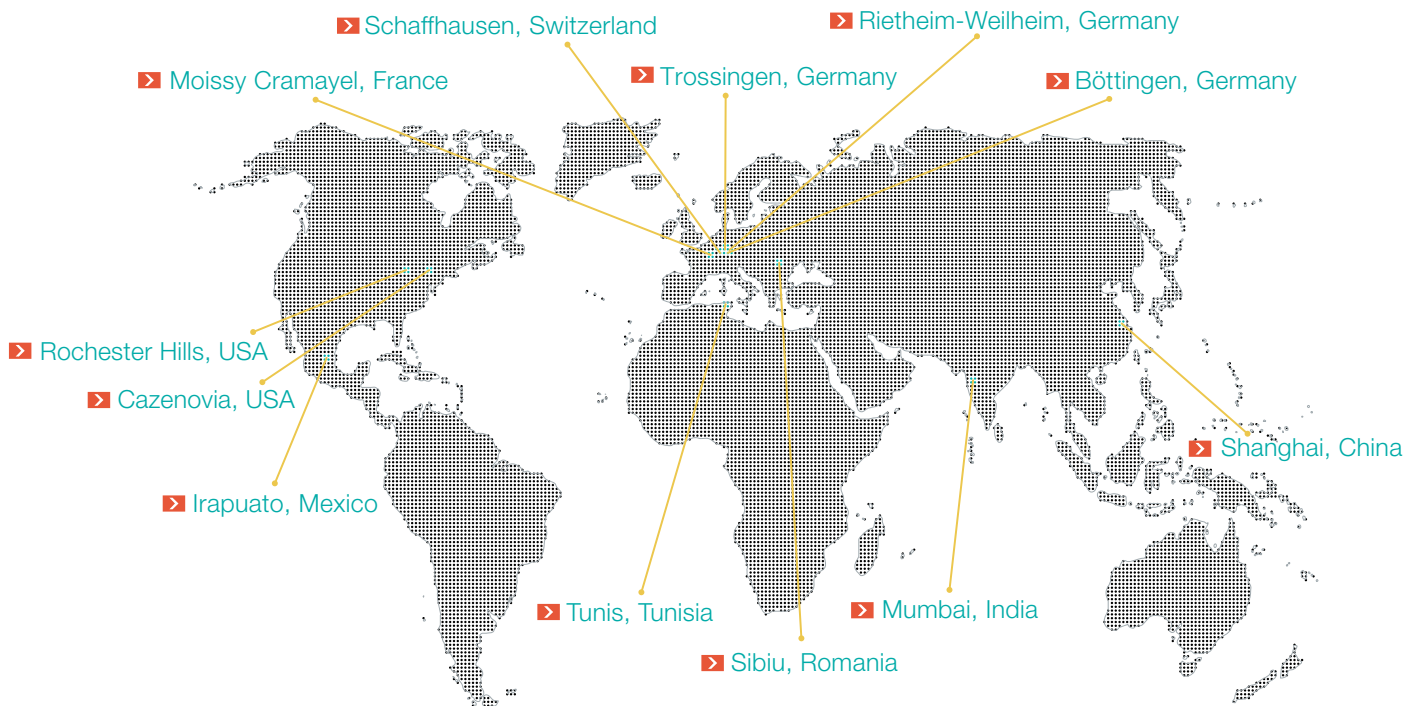

HEADQUARTERS

Marquardt Mechatronik GmbH

Schloss-Straße 16
78604 Rietheim-Weilheim / GERMANY
Tel. +49 (0)74 24/99-0
Fax +31 (0)74 24/99-2399
marquardt@marquardt.com
www.marquardt.com

Geuken



DISTRIBUTOR

GEUKEN B.V.

Wattstraat 15a
2723 RA Zoetermeer / NETHERLANDS
Tel. +31 (0)79 361 60 70
Fax +31 (0)79 361 40 90
info@geuken.nl
www.geuken.nl